



13 September 2024 – Manli Technology Group Limited is proud to announce the Manli GeForce RTX™ 4060 Polar Fox. Built with the ultra-efficient NVIDIA Ada Lovelace architecture, it brings your games and creative projects to life with accelerated ray tracing and AI-powered graphics.

Increased Performance

NVIDIA® GeForce RTX™ 40 Series GPUs are beyond fast for gamers and creators. They're powered by the ultra-efficient NVIDIA Ada Lovelace architecture which delivers a quantum leap in both performance and AI-powered graphics.

The RTX™ 4060 is equipped with 3,072 CUDA® cores, 8GB GDDR6 memory, and memory speeds of up to 17Gbps.

Manli Design

The Manli GeForce RTX™ 4060 Polar Fox features a twin cooling design with 2 x 9cm framed fan blades that centralize airflow, increasing air volume and pressure to efficiently remove heat from the base module. It also equipped with 2 copper composite heat pipes in a segmented heat sink to achieve better thermal performance. The white cooler, with an acrylic cover, combines a slim and stylish appearance. It still keeps the 2-slot design to save space while ensuring the best heat dissipation, suiting small ITX chassis perfectly.

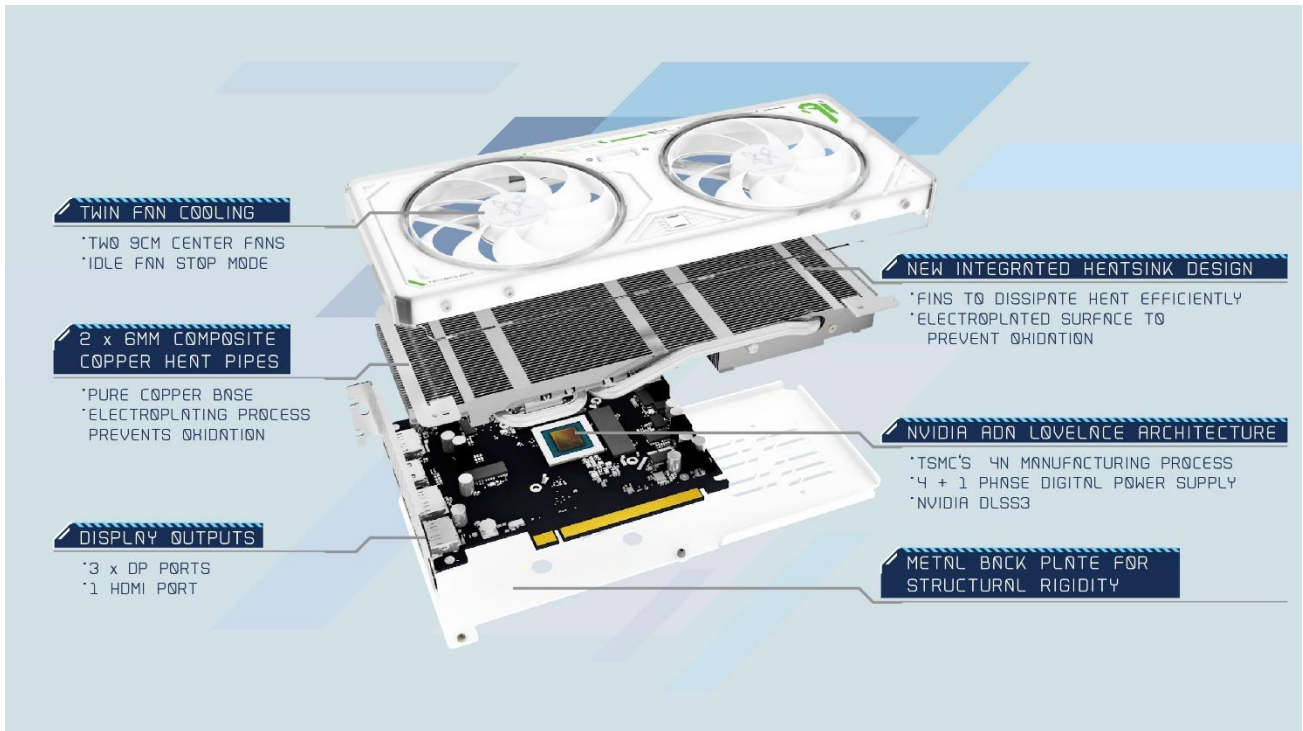

Get equipped with the Manli GeForce RTX™ 4060 Polar Fox to experience lifelike virtual worlds with ray tracing and ultra-high FPS gaming, all with the lowest latency.



About Manli Technology Group Limited

Established in 1996, Manli Technology Group Ltd. has been a major manufacturer and supplier of Computer Graphics Cards, Mining Systems, Mining Cards, and other peripherals/components. Manli has been able to fulfill various needs in the continuously changing IT industry. With an innovative R&D team and strict quality control standards, Manli's products always mean performance, reliability, and conformance. Our goal is to provide high-performance products at competitive prices.

For more information, please visit <https://www.manli.com>

Media Contact

Kent Kuo

Manli Technology Group Limited

Tel: (886) 2 – 2555 8881 # 52

Fax: (886) 2 – 2555 5829

Email: kent@manli.com.hk

manli

POLAR FOX

GeForce RTX™ 4060 Polar Fox

WHITE EDITION



Chipset		Graphics Processor	
Product Name	Manli GeForce RTX™ 4060	Tensor Cores (AI)	4th Gen 242 AI TOPS
Part Number	M-NRTX4060/6RGHPPV2-M2624	Shader Cores	Ada Lovelace 15 TFLOPS
NVIDIA CUDA® Cores	3072	Ray Tracing Cores	3rd Gen 35 TFLOPS
GPU Clock		DLSS	DLSS 3
Base	1830 MHz	Theoretical Performance	
Boost	2460 MHz	Pixel Rate	118.1 GPixel/s
Thermal /Component power		Texture Rate	236.2 GTexel/s
Idle Power (W)	7W	FP16 (half)	15.11 TFLOPS (1:1)
Video Playback Power (W)	11W	FP32 (float)	15.11 TFLOPS
Average Gaming Power (W)	110W	FP64 (double)	236.2 GFLOPS (1:64)
TGP(Total Graphics Power)	120W	Display /Interface	
Slots	2-Slot	Maximum resolutions	7680 x 4320
Card dimension (Included fan)	251 x 120 x 42mm	Display Connectors	HDMI + 3 x DP
Card dimension (PCB only)	144.75 x 111.15 x 1.6mm	PCI Express interface	PCI Express 4.0
Maximum GPU Temperature	90 °C	Packaging	
Cooling design	Heatsink with Twin Cooler	Box size	321 x 170 x 90mm
Power connector	one 8-pin	Key Features	
Memory Specifications		<ul style="list-style-type: none"> > Dedicated Ray Tracing Cores > Dedicated Tensor Cores > NVIDIA DLSS 3 > Game Ready and NVIDIA Studio Drivers > NVIDIA® GeForce Experience™ > NVIDIA Broadcast > NVIDIA G-SYNC® > NVIDIA GPU Boost™ > PCI Express® Gen 4 > Microsoft DirectX® 12 Ultimate > Vulkan RT APIs, Vulkan 1.3, OpenGL 4.6 > HDCP 2.3 > DisplayPort 1.4a, up to 4K at 240Hz or 8K at 60Hz with DSC, HDR > As specified in HDMI 2.1a: up to 4K 240Hz or 8K 60Hz with DSC, Gaming VRR, HDR > Fan-stop function at idle state to reduce noise and conserve energy 	
Standard Memory Config	8GB GDDR6		
Memory clock	8500 MHz		
Memory bus width	128 bit		
Peak memory bandwidth	Up to 272 GB/s		
Memory speed	17 Gbps		
System Requirement			
<ul style="list-style-type: none"> > PCI Express® graphics slot required > Internet connection and 2 GB available disk space for driver installation required > System space for a 2-slot card required > One PCIe 8-pin power connectors required > 550W system power supply required > 16 GB system memory recommended > Microsoft® Windows® 11 64-bit or Linux 64-bit 			

*All product photos and Specifications are subjected to change without prior notice.

www.manli.com

manli

POLAR FOX

GeForce RTX™ 4060 Polar Fox

WHITE EDITION



242
AI TOPS

3072
CUDA

1830
/
2460MHz

8 GB
GDDR6

17
Gbps



Chipset		Graphics Processor	
Product Name	Manli GeForce RTX™ 4060	Tensor Cores (AI)	4th Gen 242 AI TOPS
Part Number	M-NRTX4060/6RGHPPP-M2624	Shader Cores	Ada Lovelace 15 TFLOPS
NVIDIA CUDA® Cores	3072	Ray Tracing Cores	3rd Gen 35 TFLOPS
GPU Clock		DLSS	DLSS 3
Base	1830 MHz	Theoretical Performance	
Boost	2460 MHz	Pixel Rate	118.1 GPixel/s
Thermal /Component power		Texture Rate	236.2 GTexel/s
Idle Power (W)	7W	FPI6 (half)	15.11 TFLOPS (1:1)
Video Playback Power (W)	11W	FP32 (float)	15.11 TFLOPS
Average Gaming Power (W)	110W	FP64 (double)	236.2 GFLOPS (1:64)
TGP(Total Graphics Power)	115W	Display /Interface	
Slots	2-Slot	Maximum resolutions	7680 x 4320
Card dimension (Included fan)	251 x 120 x 42mm	Display Connectors	HDMI + 3 x DP
Card dimension (PCB only)	144.75 x 111.15 x 1.6mm	PCI Express interface	PCI Express 4.0
Maximum GPU Temperature	90 °C	Packaging	
Cooling design	Heatsink with Twin Cooler	Box size	321 x 170 x 90mm
Power connector	one 8-pin	Key Features	
Memory Specifications		<ul style="list-style-type: none"> > Dedicated Ray Tracing Cores > Dedicated Tensor Cores > NVIDIA DLSS 3 > Game Ready and NVIDIA Studio Drivers > NVIDIA® GeForce Experience™ > NVIDIA Broadcast > NVIDIA G-SYNC® > NVIDIA GPU Boost™ > PCI Express® Gen 4 > Microsoft DirectX® 12 Ultimate > Vulkan RT APIs, Vulkan 1.3, OpenGL 4.6 > HDCP 2.3 > DisplayPort 1.4a, up to 4K at 240Hz or 8K at 60Hz with DSC, HDR > As specified in HDMI 2.1a: up to 4K 240Hz or 8K 60Hz with DSC, Gaming VRR, HDR > Fan-stop function at idle state to reduce noise and conserve energy 	
Standard Memory Config	8GB GDDR6		
Memory clock	8500 MHz		
Memory bus width	128 bit		
Peak memory bandwidth	Up to 272 GB/s		
Memory speed	17 Gbps		
System Requirement			
<ul style="list-style-type: none"> > PCI Express® graphics slot required > Internet connection and 2 GB available disk space for driver installation required > System space for a 2-slot card required > One PCIe 8-pin power connectors required > 550W system power supply required > 16 GB system memory recommended > Microsoft® Windows® 11 64-bit or Linux 64-bit 			

*All product photos and Specifications are subjected to change without prior notice.

www.manli.com

* The above information shows the general technical specifications of the product and does not represent actual configuration. For specific configurations and their availability, please check with your local distributors